



PŪKAHA

is growing...



Rongo te mauri.
Feel life's essence.

Pūkaha is growing our

- ▷ Education programmes
- ▷ Commitment to our cultural heritage
- ▷ Contribution to the economy
- ▷ Role in the community

We invite you to be
part of this journey...

We're seeking organisations, groups, individuals
and families to partner with us to contribute to this
exciting development



Our National Environmental Challenge



“..... it has become quite obvious we – humans – have dangerously crossed quite a few Planetary Boundaries and we have been on a path of disconnect with Nature.

Now it is time to re-connect.

In terms of Education, let's explore the lessons Mother Nature can teach us to live on our planet with grace, elegance and understanding. Let's see if we can become a “welcome species” again and... learn from Nature, in Nature...”

Dr Ruud Kleinpaste (AKA Bugman)
AMBASSADOR - TE WĀNANGA TAIAO



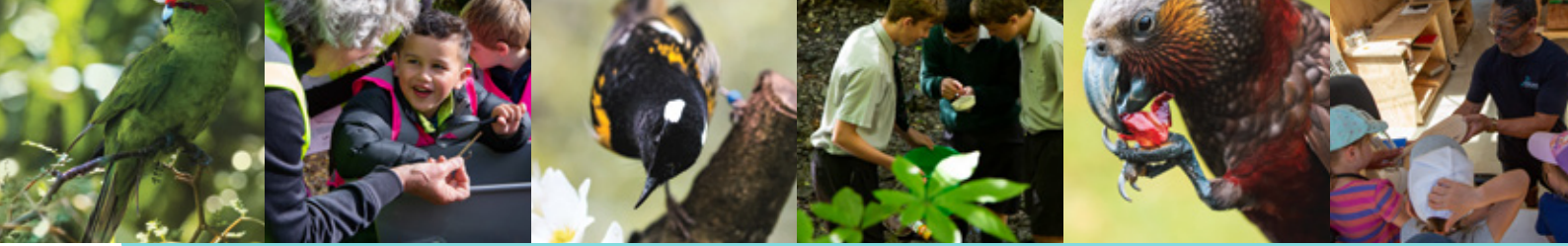

Pūkaha's Response

Pūkaha is one of New Zealand's best-equipped Outdoor Classrooms and a national treasure that can be nurtured and leveraged for the benefit of future generations and Aotearoa's environmental future.

Pūkaha's goal is to offer unique learning experiences that are sympathetic to the natural environment and its inhabitants, that educate and inspire New Zealanders to be guardians of our environment and that reconnect us all with the mauri (life force) of the forest.

The Pūkaha Board has committed to building a purpose designed Education and Accommodation Centre and to invest in enhanced education programmes. Together they will take experiences available at Pūkaha to a whole new level.

The Centre, to be known as Te Wānanga Taiao, is currently being built on the Reserve

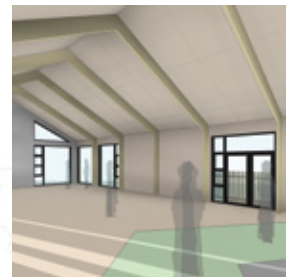
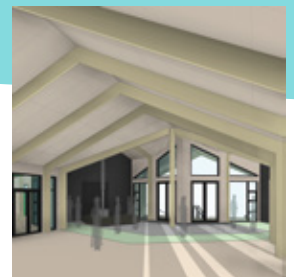

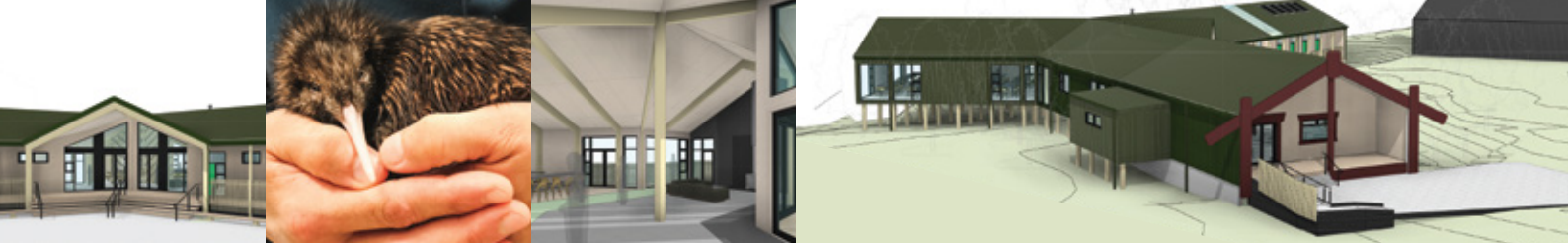

Te Wānanga Taiao



Te Wānanga Taiao will accommodate groups of up to 40 people including schools, community and business organisations.

The whare nui is a place of ceremony, of meeting and of learning that can also be used for overnight stays.

A commercial kitchen and beautiful dining area will seat 100 people and be used as a lounge with log fire in the evenings.

A special room to dry clothes is also included so everyone can enjoy the forest in all weathers and have warm dry clothes the next day.

Te Wānanga Taiao will enable visitor groups from all walks of life to come and stay at the Reserve overnight and get to experience the native forest at dawn and dusk when it really comes alive.

All access to the reserve will be by guided tours only including a new nocturnal aviary to see Kiwi in their natural outdoor habitat.



The Opportunity

We are offering you the opportunity to be part of this historic development and help make it happen.

The cost of the new Centre is \$6.5m.

We have received a government grant of \$3.7m.

We need to raise and invest \$2.8m to complete the project.

The Centre will be completed and open by June 2023.



The opportunities to participate financially include donations to sponsorship and collective contributions.

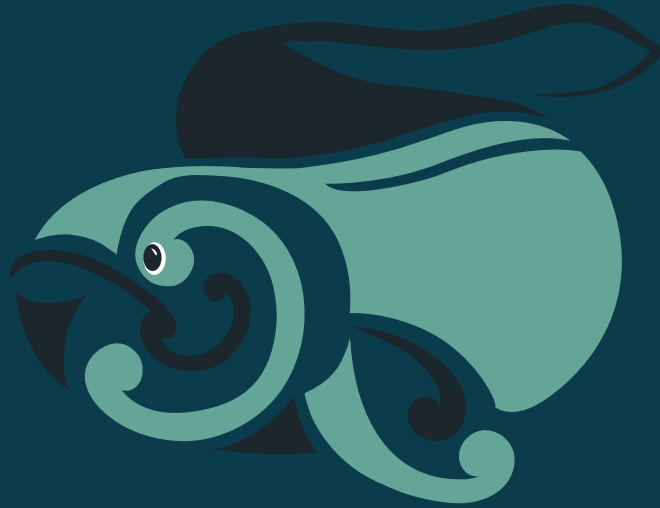

Donations

All donations gratefully received and publicly acknowledged. Pūkaha is a registered charity, so any donations can be claimed as tax deduction. The donations could be in cash or kind. For example we will need: furnishing, floor coverings, heating, kitchen equipment, IT systems, landscaping and more.

Sponsorship

Te Wānanga Taiao includes a number of wonderful opportunities to make a lasting difference through sponsorship. These include sponsoring the cost of bedrooms, bunkrooms, whare nui, kitchen, dining room / lounge or drying room or furniture fitout items. A sponsorship of this nature would attract naming rights for the life of the building and public recognition. The sponsor(s) may also wish to discuss the inclusion of their sponsorship as part of their marketing and promotions programme.



Group fundraising on behalf of Pūkaha

Another opportunity is your organization, business or community group could opt to set a fundraising target and fundraise for the project as a whole or a specific item such as a room or some equipment. If you do this we will help with promotional material and will authorise your use of the Pūkaha branding in partnership with your organization.



Next Steps

This is the most ambitious project we have ever undertaken and will benefit our communities for years to come

We look forward to your support

Please contact our General Manager
Emily Court for more information
and a confidential discussion

M 027 594 2928

E emily@Pūkaha.org.nz



He waka eke noa.
We are all in this together.



PŪKAHA

NATIONAL WILDLIFE CENTRE

Rongo te mauri